



**Luoyang JCB Bearing Technology Company Limited**

**134.25.560**

# **SLEWING BEARING**

**THREE ROW ROLLER SLEWING BEARING**





# Luoyang JCB Bearing Technology Company Limited

## CONTENTS

01.

[MAIN SPECIFICATION](#)

02.

[TECHNICAL INFORMATION](#)

03.

[MANUFACTURE & INSPECTION](#)

04.

[PACKING AND STORAGE](#)

05.

[WARRANTY & CERTIFICATE](#)



**Luoyang JCB Bearing Technology Company Limited**

**134.25.560**

**01**

## MAIN SPECIFICATION

- REFERENCE DRAWING
- SPECIFICATION
- RAW MATERIAL
- LUBRICATIONA
- BOLT HOLES TYPE & BOLTS
- CORROSION PROTECTION



# Luoyang JCB Bearing Technology Company Limited

## 134.25.560

### REFERENCE DRAWING

This drawing is reference for user, if user request for formal drawing , please contact with us: [sales@jcb-bearing.com](mailto:sales@jcb-bearing.com), the official drawing will be submitted to them.

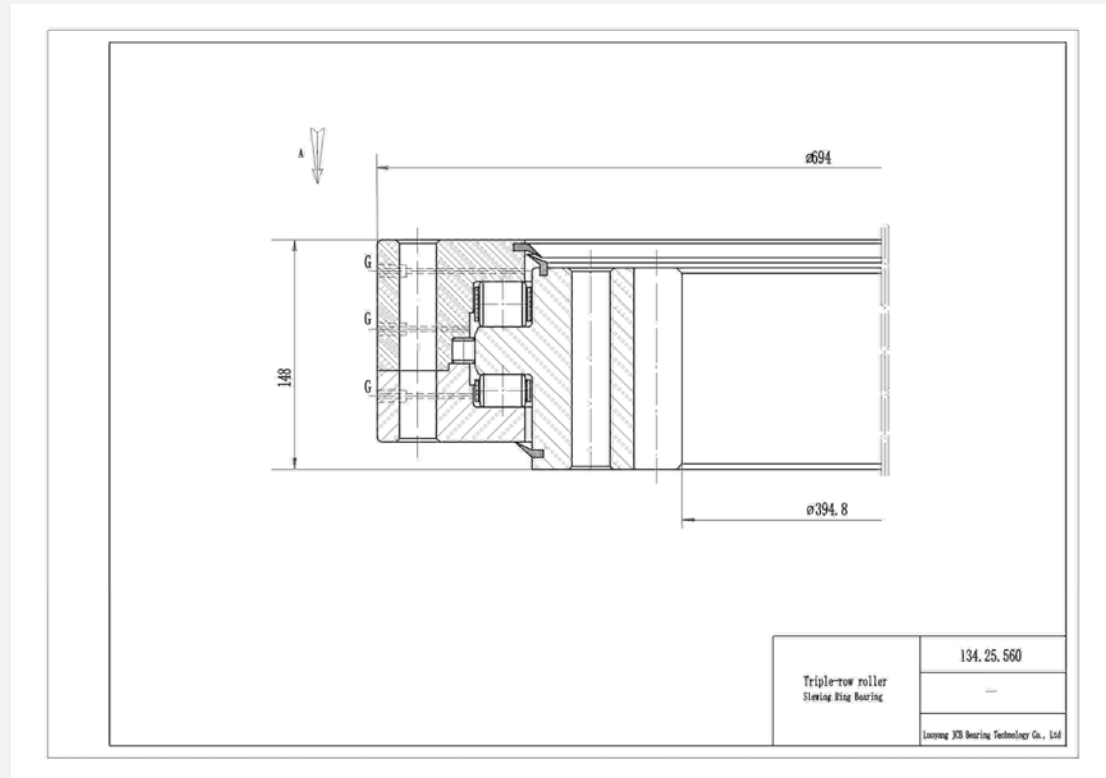

01-1

01-2

# Luoyang JCB Bearing Technology Company Limited

## SPECIFICATION



### 134.25.560

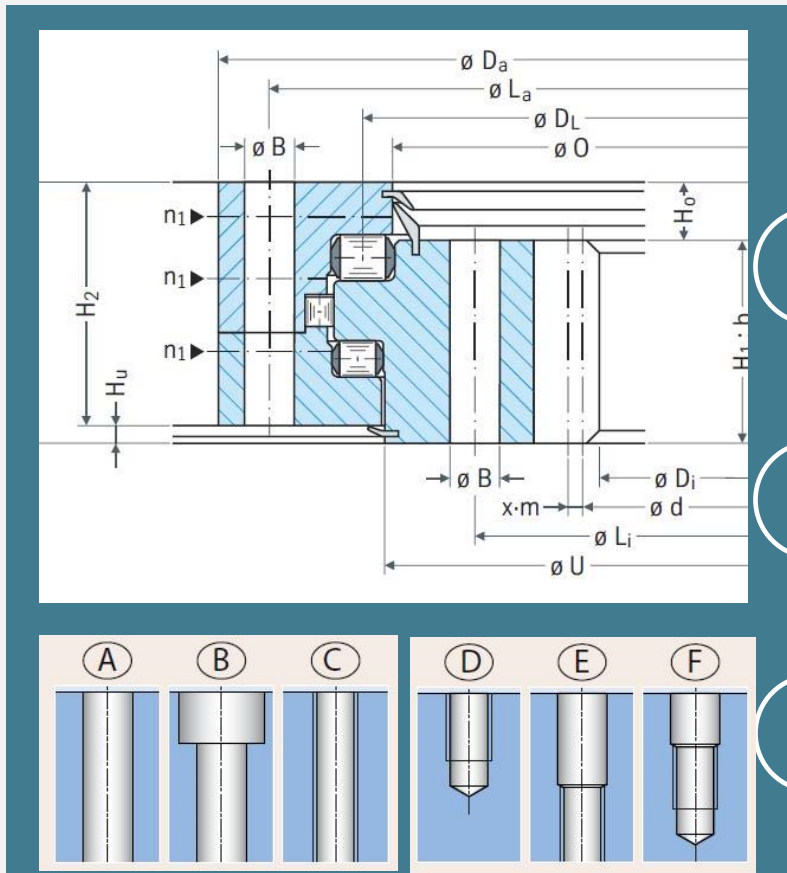

- Inner diameter ( $D_i$ ) :398.4
- Outer diameter ( $D_a$ ) :694
- Overall height ( $H$ ) :148
- Outer ring height ( $H_2$ ):138
- Inner ring height ( $H_1$ ):116
- Weight: 240 KG
- External bolt circle dia ( $L_a$ ) : 658
- Number of bolt holes per hole circle ( $n_a$ ) :24
- External bolt hole type : Selected by user
- External bolt hole diameter( $B$ ) :18
- Internal bolt circle dia( $L_i$ ): 462
- Number of bolt holes per hole circle( $n_i$ ): 24
- Internal bolt hole type : Selected by user
- Internal bolt hole diameter ( $B$ ) :18
- Tooth number( $z$ ) :67
- Module of gear( $m$ ) :6
- Tooth width ( $b$ ) : 80