



Luoyang JCB Bearing Technology Company Limited

192.50.6300.990.41.1502

SLEWING BEARING

THREE ROW ROLLER SLEWING BEARING





Luoyang JCB Bearing Technology Company Limited

CONTENTS

01.

[MAIN SPECIFICATION](#)

02.

[TECHNICAL INFORMATION](#)

03.

[MANUFACTURE & INSPECTION](#)

04.

[PACKING AND STORAGE](#)

05.

[WARRANTY & CERTIFICATE](#)



Luoyang JCB Bearing Technology Company Limited

192.50.6300.990.41.1502

01

MAIN SPECIFICATION

- [REFERENCE DRAWING](#)
- [SPECIFICATION](#)
- [RAW MATERIAL](#)
- [LUBRICATIONA](#)
- [BOLT HOLES TYPE & BOLTS](#)
- [CORROSION PROTECTION](#)



Luoyang JCB Bearing Technology Company Limited

192.50.6300.990.41.1502

REFERENCE DRAWING

This drawing is reference for user, if user request for formal drawing , please contact with us: sales@jcb-bearing.com, the official drawing will be submitted to them.

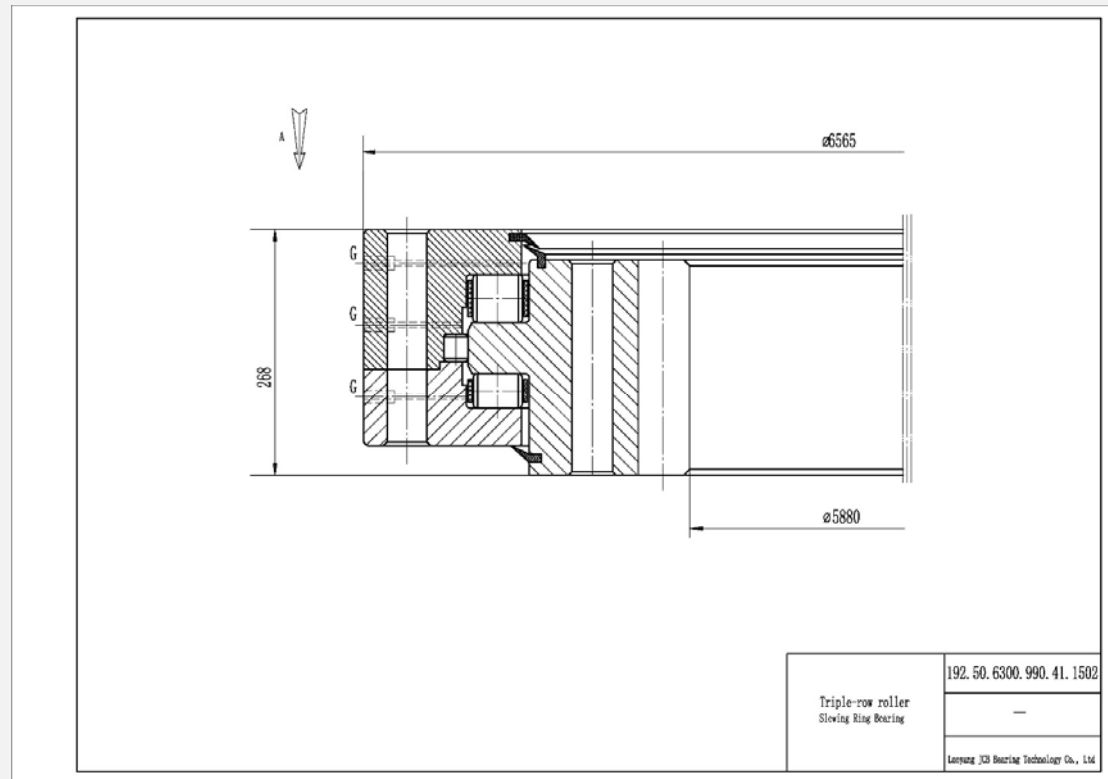

01-1

01-2

Luoyang JCB Bearing Technology Company Limited



SPECIFICATION

192.50.6300.990.41.1502

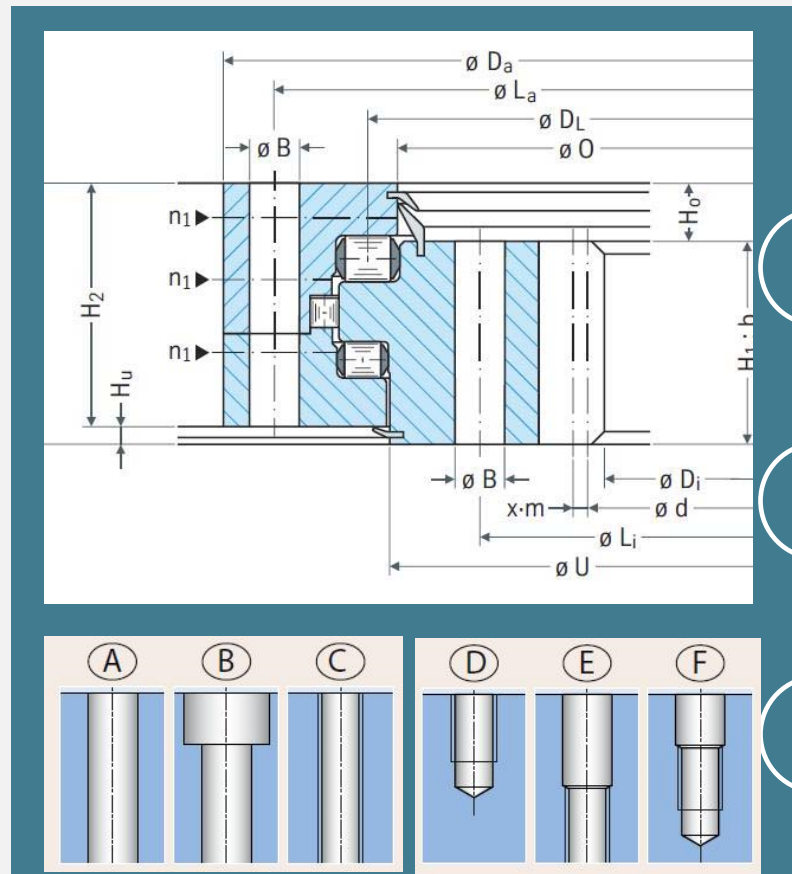

Inner diameter (D_i) :5880
Outer diameter (D_a) :6565
Overall height (H) :268
Outer ring height (H_2):258
Inner ring height (H_1):203
Weight: 10555 KG
External bolt circle dia (L_a) : 6475
Number of bolt holes per hole circle (n_a) :100
External bolt hole type : Selected by user
External bolt hole diameter(B) :45
Internal bolt circle dia(L_i): 6100
Number of bolt holes per hole circle(n_i): 100
Internal bolt hole type : Selected by user
Internal bolt hole diameter (B) :45
Tooth number(z) :246
Module of gear(m) :24
Tooth width (b) : 203