



Luoyang JCB Bearing Technology Company Limited

3R6-71N9

SLEWING BEARING

THREE ROW ROLLER SLEWING BEARING





Luoyang JCB Bearing Technology Company Limited

CONTENTS

01.

[MAIN SPECIFICATION](#)

02.

[TECHNICAL INFORMATION](#)

03.

[MANUFACTURE & INSPECTION](#)

04.

[PACKING AND STORAGE](#)

05.

[WARRANTY & CERTIFICATE](#)



Luoyang JCB Bearing Technology Company Limited

3R6-71N9

01

MAIN SPECIFICATION

- [REFERENCE DRAWING](#)
- [SPECIFICATION](#)
- [RAW MATERIAL](#)
- [LUBRICATIONA](#)
- [BOLT HOLES TYPE & BOLTS](#)
- [CORROSION PROTECTION](#)



Luoyang JCB Bearing Technology Company Limited

3R6-71N9

REFERENCE DRAWING

This drawing is reference for user, if user request for formal drawing , please contact with us: sales@jcb-bearing.com, the official drawing will be submitted to them.

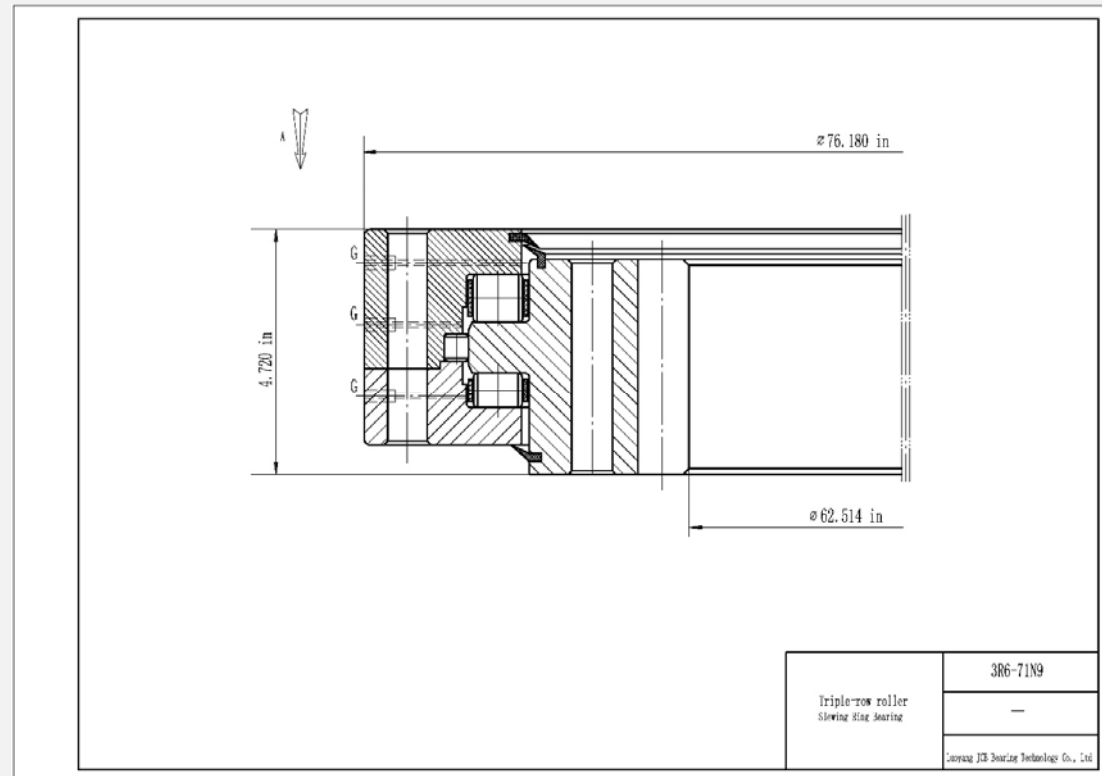

01-2

Luoyang JCB Bearing Technology Company Limited

SPECIFICATION



3R6-71N9

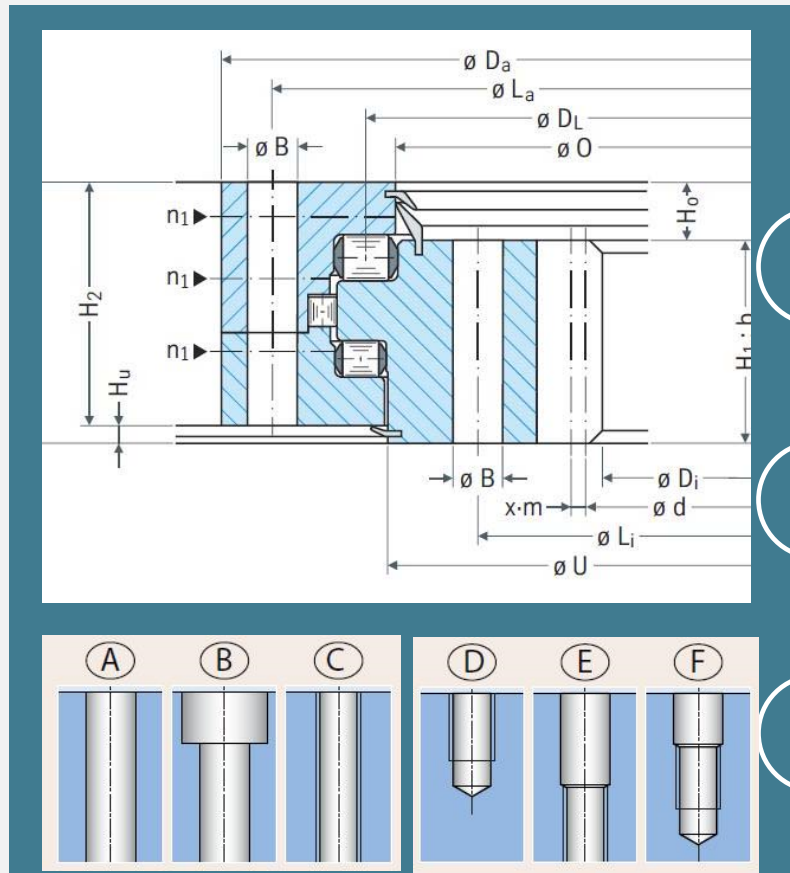

- Inner diameter (d_i): 62.514 in
- Outer diameter (D_a): 76.180 in
- Overall height (H): 4.720 in
- Outer ring height (H_o): 4.410 in
- Inner ring height (H_i): 3.700 in
- Weight: 1391 lbs
- External bolt circle dia (L_o): 74.606 in
- Number of bolt holes per hole circle (n_o): 46
- External bolt hole type : Selected by user
- External bolt hole diameter (B_o): 1.02 in
- Internal bolt circle dia (L_i): 66.732 in
- Number of bolt holes per hole circle (n_i): 46
- Internal bolt hole type : Selected by user
- Internal bolt hole diameter (B_i): 1.02 in
- Tooth number (z): 111
- Module of gear (DP): 1.75
- Tooth width (b_2): 3.390 in