



**Luoyang JCB Bearing Technology Company Limited**

**3R8-98N9**

**SLEWING BEARING**

**THREE ROW ROLLER SLEWING BEARING**





# Luoyang JCB Bearing Technology Company Limited

## CONTENTS

01.

[MAIN SPECIFICATION](#)

02.

[TECHNICAL INFORMATION](#)

03.

[MANUFACTURE & INSPECTION](#)

04.

[PACKING AND STORAGE](#)

05.

[WARRANTY & CERTIFICATE](#)



**Luoyang JCB Bearing Technology Company Limited**

**3R8-98N9**

01

## MAIN SPECIFICATION

- [REFERENCE DRAWING](#)
- [SPECIFICATION](#)
- [RAW MATERIAL](#)
- [LUBRICATIONA](#)
- [BOLT HOLES TYPE & BOLTS](#)
- [CORROSION PROTECTION](#)



# Luoyang JCB Bearing Technology Company Limited

## 3R8-98N9

### REFERENCE DRAWING

This drawing is reference for user, if user request for formal drawing , please contact with us: [sales@jcb-bearing.com](mailto:sales@jcb-bearing.com), the official drawing will be submitted to them.

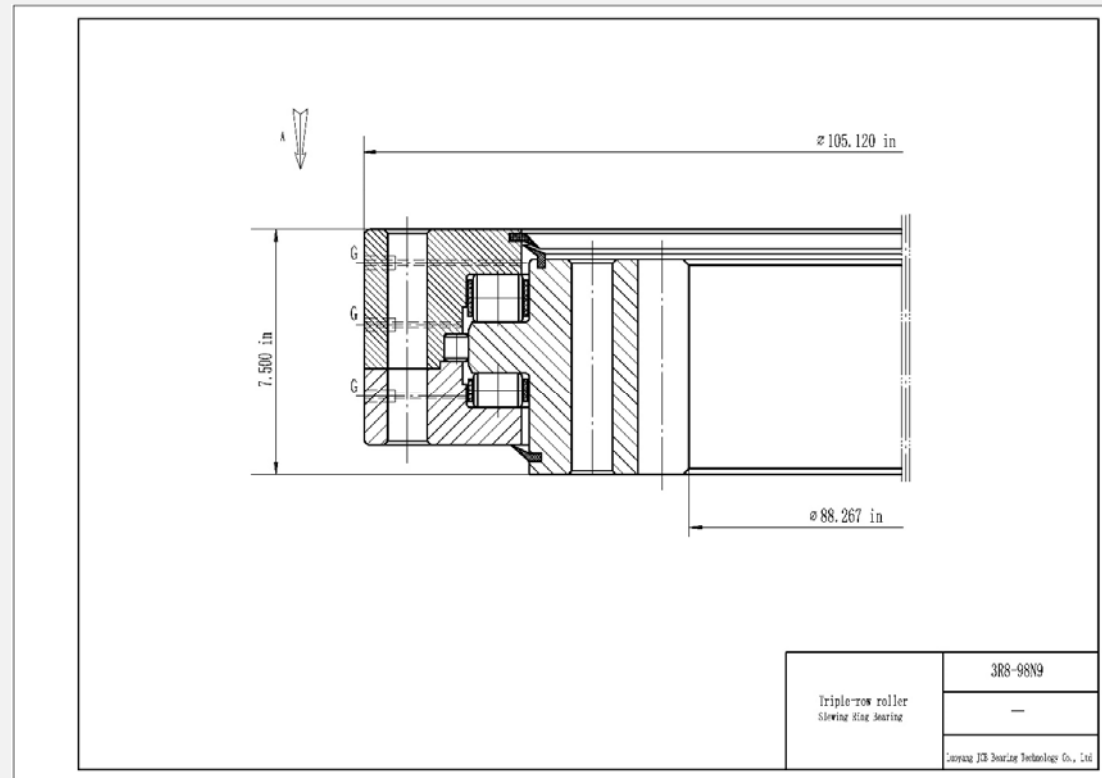

# Luoyang JCB Bearing Technology Company Limited

## SPECIFICATION



### 3R8-98N9

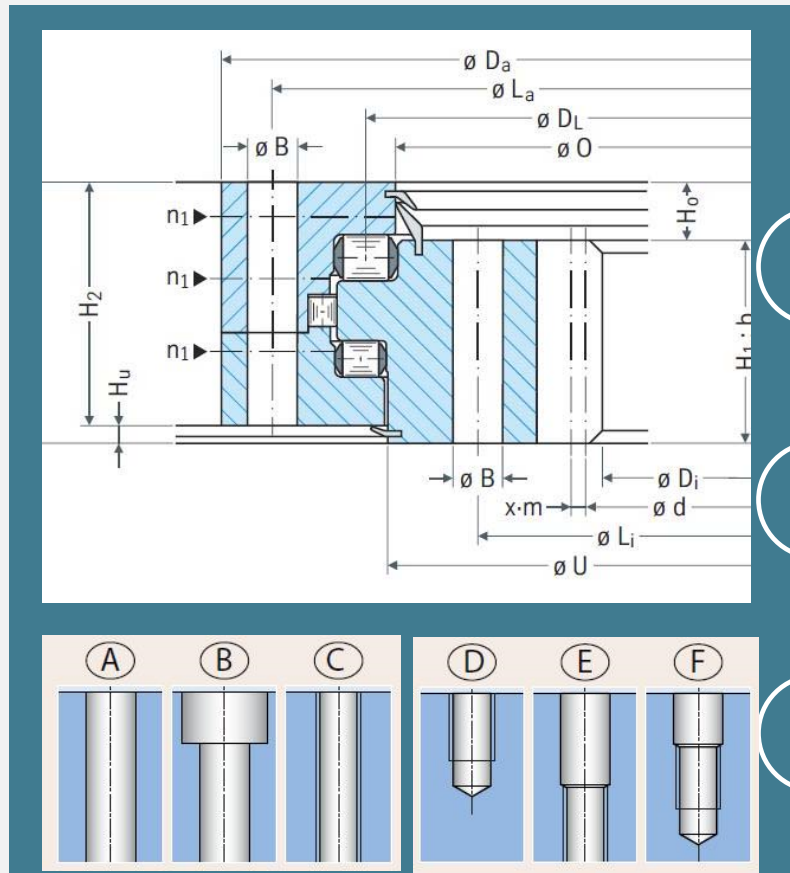

Inner diameter (di): 88.267 in  
 Outer diameter (Da): 105.120 in  
 Overall height (H): 7.500 in  
 Outer ring height (Ho): 6.880 in  
 Inner ring height (Hi): 7.060 in  
 Weight: 2928 lbs  
 External bolt circle dia (Lo): 90.250 in  
 Number of bolt holes per hole circle (no):44  
 External bolt hole type : Selected by user  
 External bolt hole diameter (Bo): 1.31 in  
 Internal bolt circle dia (Li): 79.250 in  
 Number of bolt holes per hole circle (ni):44  
 Internal bolt hole type : Selected by user  
 Internal bolt hole diameter (Bi): 1.31 in  
 Tooth number (z):73  
 Module of gear (DP):1  
 Tooth width (b2): 6.260 in